

DC Motor TW-365PM Series

OUTPUT POWER: 1.0 – 35W (APPROX)

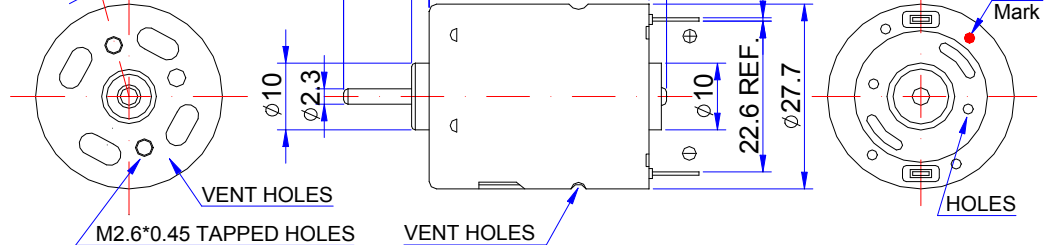

DIRECTION OF ROTATION

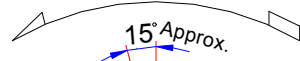

Typical Application:

1. Household Appliances:
 - a) Hairdryer
 - b) Massager
 - c) Vibrator
 - d) Corn Popper.
2. Other Applications As Customer's Needs.

Shaft Length (A): 51.0 57.0
Shaft Extension (B): 15.2 21.1

* Carbon Brush Motor. * Metal Bottom Cap. Weight: 54g (APPROX)

ELECTRICAL SPECIFICATION CHART: (The following specifications can be changed as customers' requirement)

Model	Voltage		At No Load		At Max Efficiency					Stall Torque
	Workable Range		Nominal RPM	Speed A	Current RRPM	Speed A	Current G.CM	Torque W	Output %	G.CM
TW-365PM-2080	6.0~20.0	12.0V Constant	13200	0.20	10620	0.82	55.8	6.1	61.7	286
		18.0V Constant	20600	0.21	17060	1.00	62.9	11.0	60.4	367
TW-365PM-2650	3.0~12.0	12.0V Constant	25500	0.40	20930	1.83	54.6	11.7	52.5	305

CHARACTERISTIC CURVES:

