

TW-60RS775



Main voltage: 6VDC、12VDC、24VDC、36VDC

Typical applications: Pan/Tilt camera, Cleaning machine, Garbage disposers, Angular telescope, Automatic doors, Peritoneal machine, Electric advertising, Amusement equipment, Card conveyors, Office equipment, Household appliances, Automatic actuator.

Weight: 800~1000g/pcs (approx)

Packing details: CTN size: 35X26XH19cm 10pcs/CTN G.W. 10Kgs

APPEARANCE SIZE

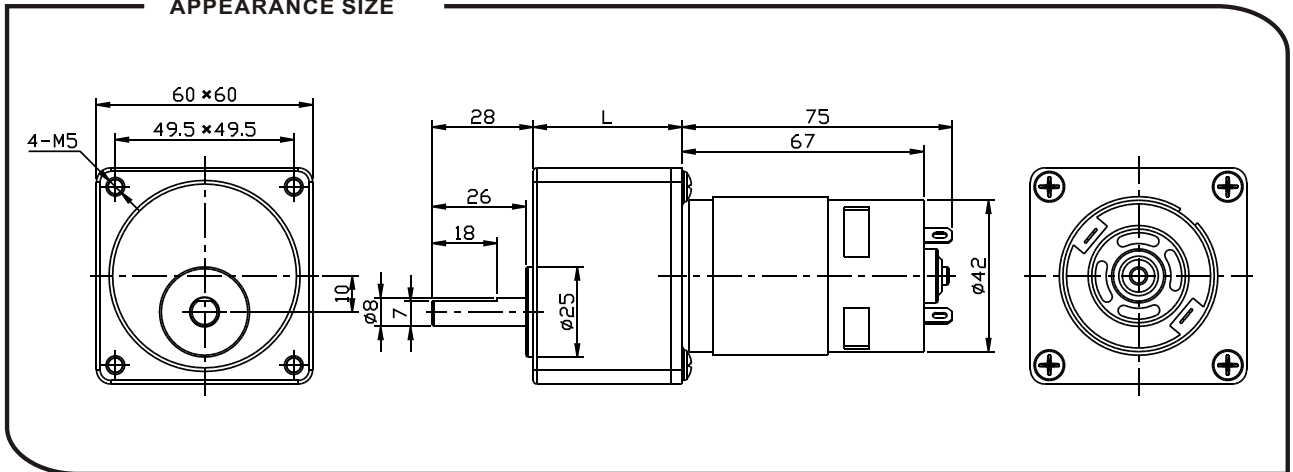

Gearbox data:

Number of stages	2、3 stages reduction	4 stages reduction	5stages reduction
Reduction ratio	9.7、10、13、13.5、18.8、19.6、29、30、39、40、56、58	87、90、117、122、169、176	261、272、351、366、507、529
Gearbox length "L" mm	31.3	41.3	41.3
Max. Running torque	10Kgf • cm	50Kgf • cm	50Kgf • cm
Max. Gear breaking torque	30Kgf • cm	150Kgf • cm	150Kgf • cm
Max. Gearing efficiency	81%；73%	65%	59%

Other reduction ratio please telephone or e-mail to our engineering department.

Motor data:

Motor name	Rated Volt. V	No load		Load torque				Stall torque	
		Current	Speed	Current	Speed	Torque	Output power	Torque	Current
		mA	r/min	mA	r/min	gf • cm	W	gf • cm	A
RS-775123000	12	≤220	3000	≤1000	2200	350	7.7	1400	3.5
RS-7751245 00	12	≤450	4500	≤2000	3300	500	16.5	2000	6.5
RS-775126000	12	≤900	6000	≤4000	4500	750	34	3000	13.0
RS-775243000	24	≤110	3000	≤500	2200	350	7.7	1400	1.8
RS-775244500	24	≤230	4500	≤1000	3300	500	16.5	2000	3.3
RS-775246000	24	≤450	6000	≤2000	4500	750	34	3000	7.0

1. This table lists some motors parameters, others please refer to specific parameters of Page 149.

2. After connecting motor and gearbox which is named gearmotor the output torque: motor torque X reduction ratio X gearing efficiency; output speed: motor speed / reduction ratio.