

DC Motor TW-130 Series

OUTPUT POWER: 0.2 - 10W (APPROX)

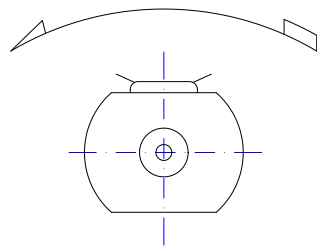

DIRECTION OF ROTATION



Typical Application:

1. Motorized toys.
2. Motorized plastic moulds.

Weight: 17g (Approx.)

(mm)

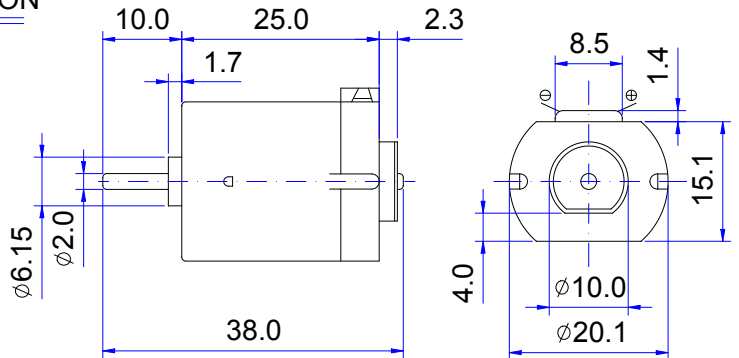

METAL BRUSH, PRECISION METAL BRUSH AND CARBON BRUSH MOTORS ARE ALL AVAILABLE.

ELECTRICAL SPECIFICATION CHART: (The following specifications can be changed as customers' requirement)

Model	Voltage		At No Load		At Max Efficiency					Stall
	Workable Range		Nominal RPM	Speed A	Current RRPM	Speed A	Current G.CM	Torque W	Output %	Torque G.CM
TW-130-12230	1.5~4.5V	3.0V CONSTANT	5500	0.05	4100	0.13	5.39	0.23	57.2	21
TW-130-15160	1.5~4.5V	3.0V CONSTANT	8700	0.09	6400	0.25	7.76	0.51	69.1	30
TW-130-16120	1.5~4.5V	3.0V CONSTANT	12000	0.12	8900	0.34	6.48	0.59	57.1	25
TW-130-18100	1.5~4.5V	3.0V CONSTANT	12500	0.15	9500	0.50	8.36	0.81	54.4	36
TW-130-1985	1.5~4.5V	3.0V CONSTANT	15700	0.20	11900	0.64	9.10	1.22	66.8	42
TW-130-2270	1.5~4.5V	3.0V CONSTANT	16500	0.25	12700	0.82	10.4	1.34	54.7	46
TW-130-2750	1.5~4.5V	3.0V CONSTANT	12600	0.26	9500	0.77	6.57	0.64	55.0	27
TW-130-2750	1.5~4.5V	3.0V CONSTANT	22000	0.37	17000	1.19	9.90	1.75	49.1	42

CHARACTERISTIC CURVES:

